

ALBEMARLE COUNTY

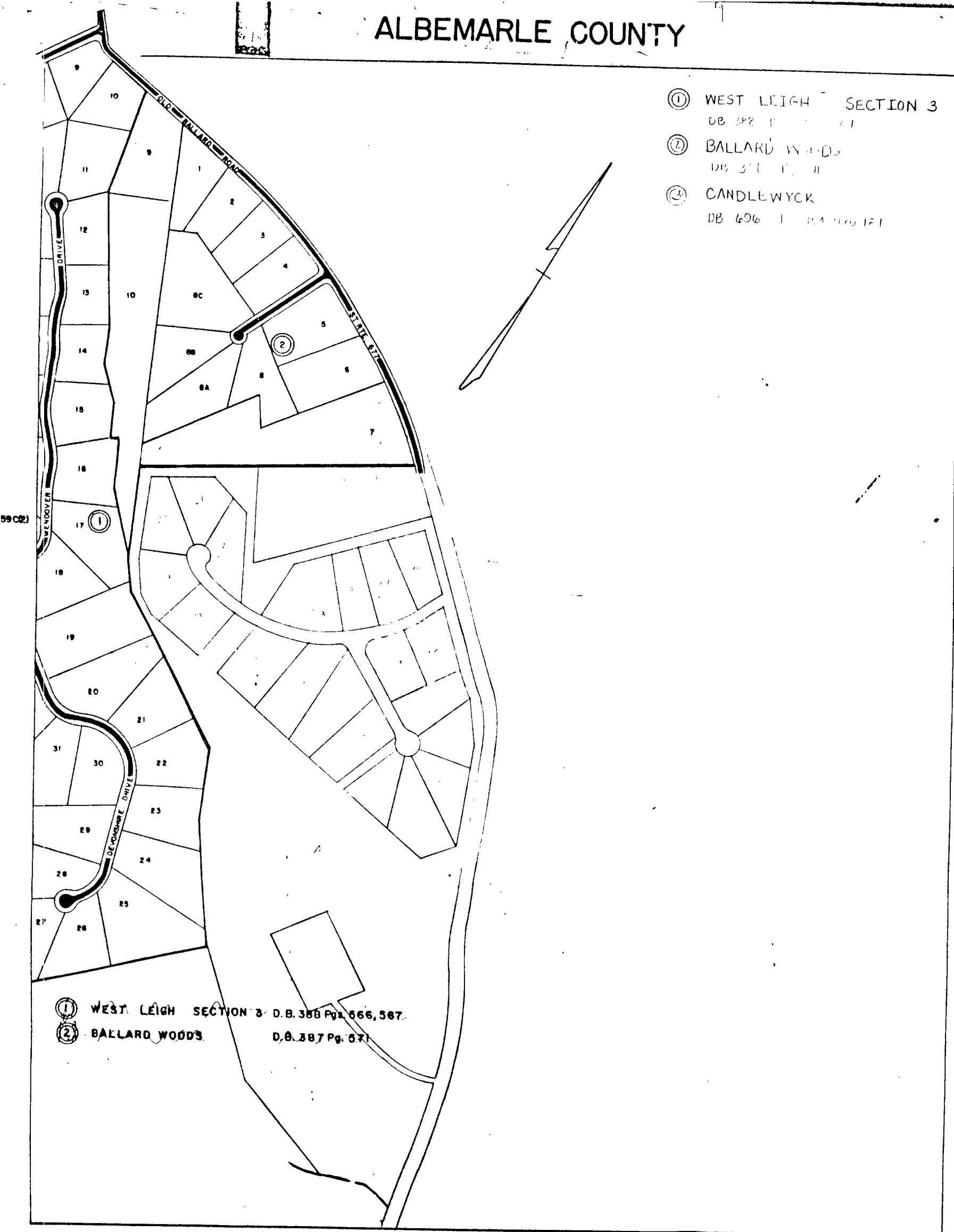

- ① WEST LEIGH SECTION 3
DB 388 Pg. 566, 567
- ② BALLARD WOODS
DB 387 Pg. 571
- ③ CANDLEWYCK
DB 696 Pg. 104, 105, 121

① WEST LEIGH SECTION 3 D.B. 388 Pg. 566, 567
② BALLARD WOODS D.B. 387 Pg. 571

