

ALBEMARLE COUNTY

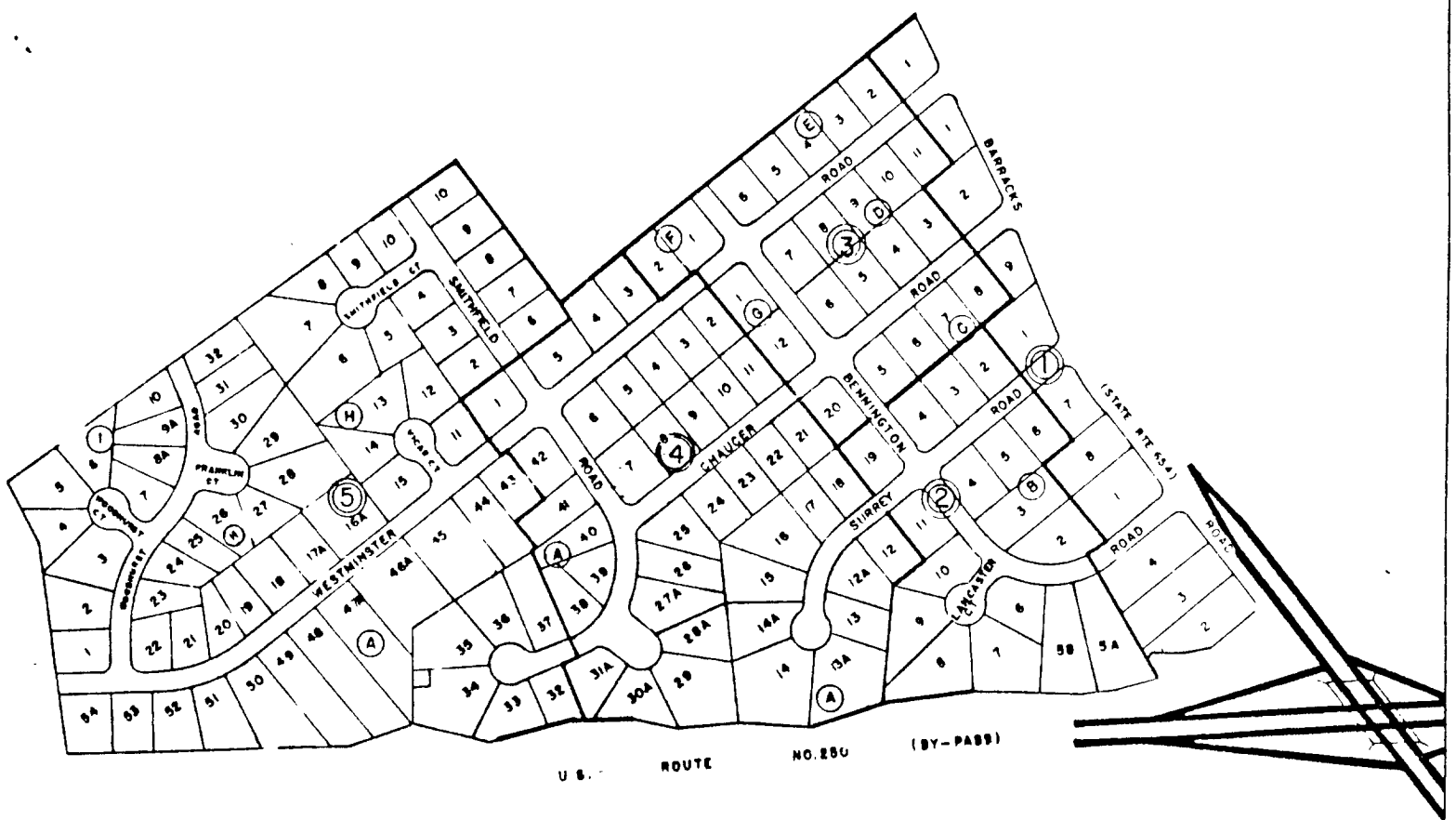

- ① CANTERBURY HILLS — SECTION 1 — D.B. 388 Pg. 576
- ② CANTERBURY HILLS — SECTION 2 — D.B. 392 Pg. 374
- ③ CANTERBURY HILLS — SECTION 3 — D.B. 393 Pg. 295
- ④ CANTERBURY HILLS — SECTION 4 — D.B. 454 Pgs. 148 & 149
- ⑤ CANTERBURY HILLS — SECTION 5 — D.B. 485 Pg. 522

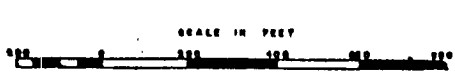

JACK JOUETT DISTRICT

SECTION 60D