

ALBEMARLE COUNTY

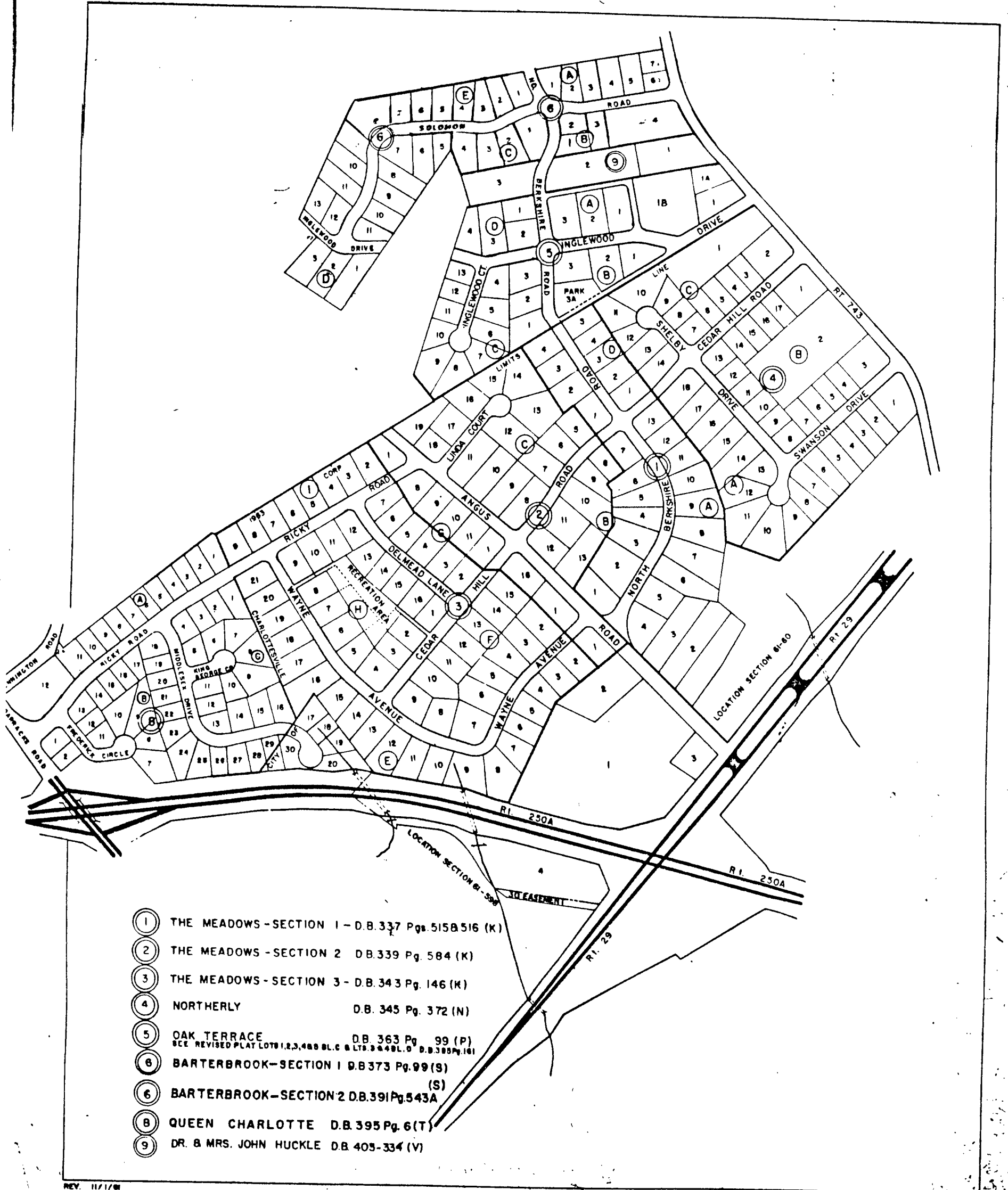

- ① THE MEADOWS - SECTION 1 - D.B. 337 Pgs. 515B 516 (K)
- ② THE MEADOWS - SECTION 2 DB. 339 Pg. 584 (K)
- ③ THE MEADOWS - SECTION 3 - D.B. 343 Pg. 146 (K)
- ④ NORTHERLY D.B. 345 Pg. 372 (N)
- ⑤ OAK TERRACE DB. 363 Pg. 99 (P)
SEE REVISED PLAT LOTS 1, 2, 3, 4 & 5 B.L.C. & LOTS 6 & 7 B.L.D. D.B. 380 Pg. 161
- ⑥ BARTERBROOK - SECTION 1 D.B. 373 Pg. 99 (S)
- ⑦ BARTERBROOK - SECTION 2 D.B. 391 Pg. 543A (S)
- ⑧ QUEEN CHARLOTTE D.B. 395 Pg. 6 (T)
- ⑨ DR. & MRS. JOHN HUCKLE D.B. 405-334 (V)

REV. 11/1/81

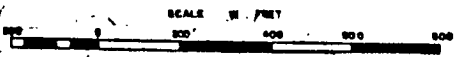

CHARLOTTESVILLE DISTRICT

SECTION 61-K