

ALBEMARLE COUNTY

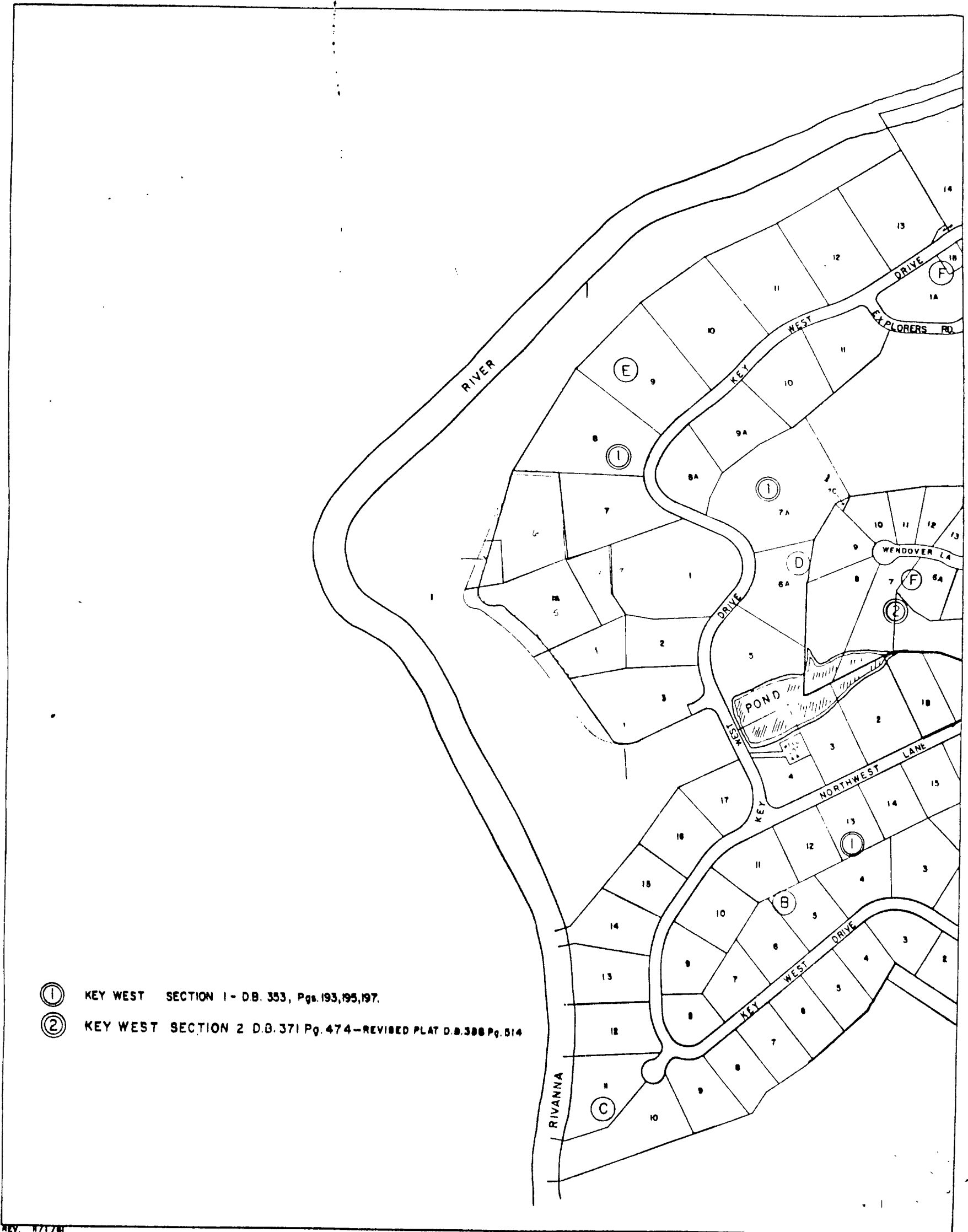

62B(1)

- ① KEY WEST SECTION 1 - D.B. 353, Pgs. 193, 195, 197.
- ② KEY WEST SECTION 2 D.B. 371 Pg. 474 - REVISED PLAT D.B. 388 Pg. 514

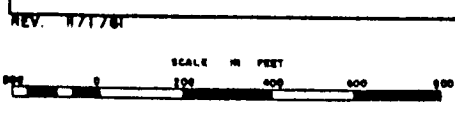

RIVANNA DISTRICT

SECTION 62B(1)